

LEDone[®]

Installation Guide



- Please keep this Quick Installation Guide for future reference.
- Product is not dimmable.
- Modifications to the product void the Warranty.

Installation Guide:

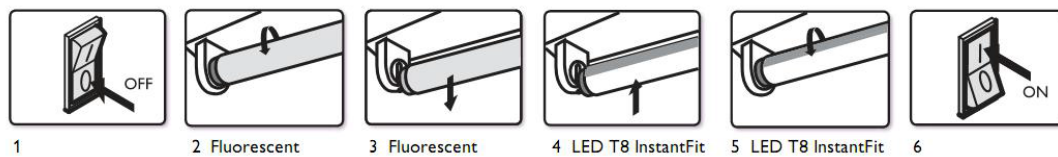

Instructions:

1. Switch-off power to the luminaire.
2. Remove diffuser (if provided).
3. Remove the existing fluorescent lamps from the luminaire.
4. Put on LED T8 Tube (one for each fluorescent lamp removed).
5. Replace diffuser (if removed in step 2)
6. Switch on power to the luminaire.

Wire Diagram:

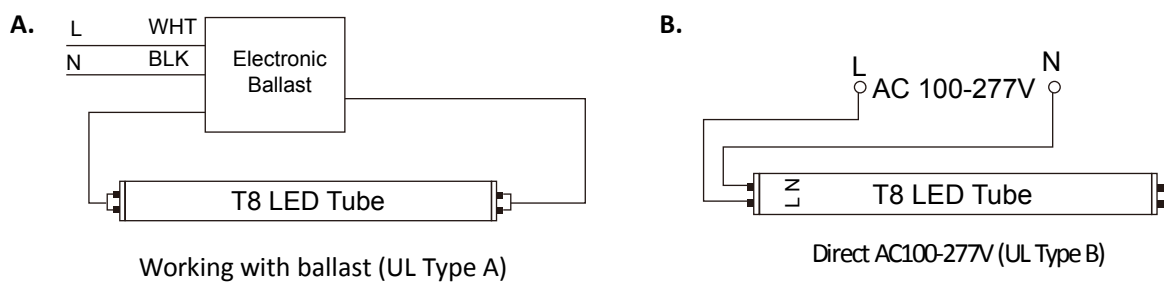

CAUTION:

- IF THE LAMP OR LUMINAIRE EXHIBITS UNDEIREABLE OPERATION (BUZZING, FLICKERING, ETC), IMMEDIATELY TURN OFF POWER, REMOVE LAMP FROM LUMINAIRE AND CONTACT THE MANUFACTURER.
- THESE DEVICES ARE NOT INTENDED FOR USE WITH EMERGENCY EXIT FIXTURES OR EMERGENCY EXIT LIGHTS.
- THIS LAMP ONLY OPERATES ON ELECTRONIC BALLASTS. IF LAMP DOES NOT LIGHT WHEN THE LUMINAIRE IS ENERGIZED, REMOVE LAMP FROM LUMINAIRE AND CONTACT LAMP MANUFACTURE OR QUALIFIEDELECTRICIAN.
- RISH OF FIRE, DO NOT INSTALL IN A PRE-HEAT LUMINAIRE, SUITABLE USE IN DRY OR DAMP LOCATION
- RISK OF FIRE, LOOSE CONTACT OR WRONG INSTALLING MAY CAUSE ARCING LEAD TO FIRE. IF LAMP-HOLDERS ARE DAMAGED, CORRODED, CHARRED, BLACKENED, OR LOOSE, CONTACT A QUALIFIED ELECTRICIAN FOR PROPER REPLACEMENT.